

COMMISSIONERS

J.P. "RICK" CARNEY  
Chairman  
JEANNE McNAMARA  
Vice Chairman  
CHARLOTTE MUSHOW  
Secretary

# Bloomingtondale 27

ROBERT T. SAAR  
Executive Director

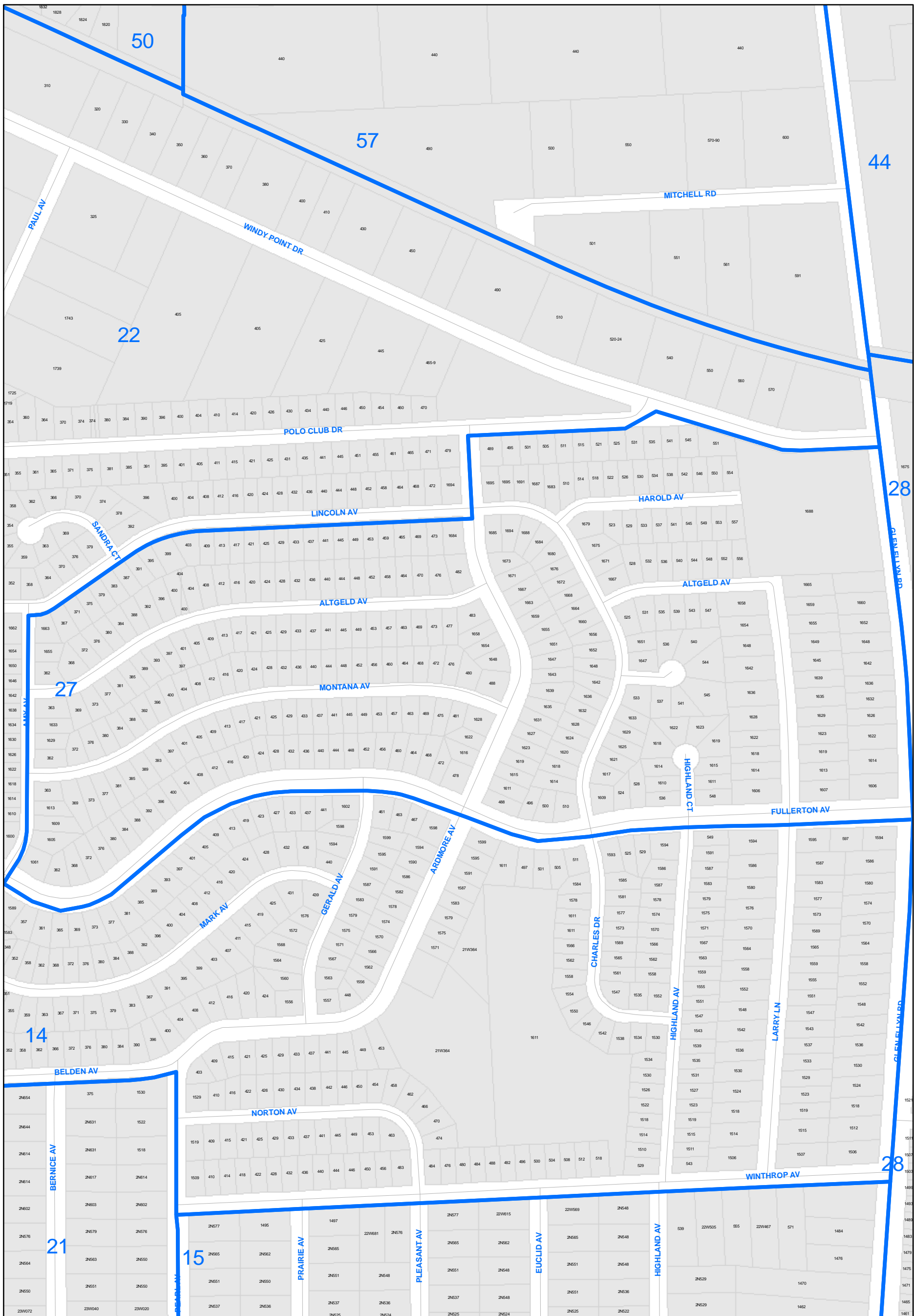

**Legend**

- DuPage Precincts
- Parcels\_2006



Sep 26, 2006

## DuPage County Election Commission

DISCLAIMER: The accuracy of this map is limited to quality of data contained in other public records. This is not a substitute for an actual field survey or field investigation.